



**SPECIFICATIONS**

Rated Current:1.0AMP  
 Contact Resistance:20mΩ Max  
 Withstand Voltage:500V AC/DC  
 Insulation Resistance:1000MΩ Min  
 Operation Temperature:-40°c to +105°c

Contact Material:Brass  
 Contact Plating:Au or Sn Over Ni  
 Insulator Material:Polyester(UL94V-0)  
 Resistance To Soldering Heat:  
 245° C±5° C, 10s(PBT insulator)  
 260° C±5° C, 10s(PA6T&PA9T&LCP insulator)

Recommended P.C.B Layout(Top Side)  
 (PCB BOARD TOLERANCE±0.05)

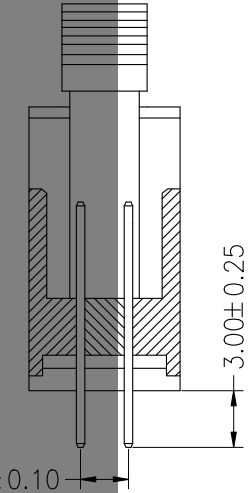
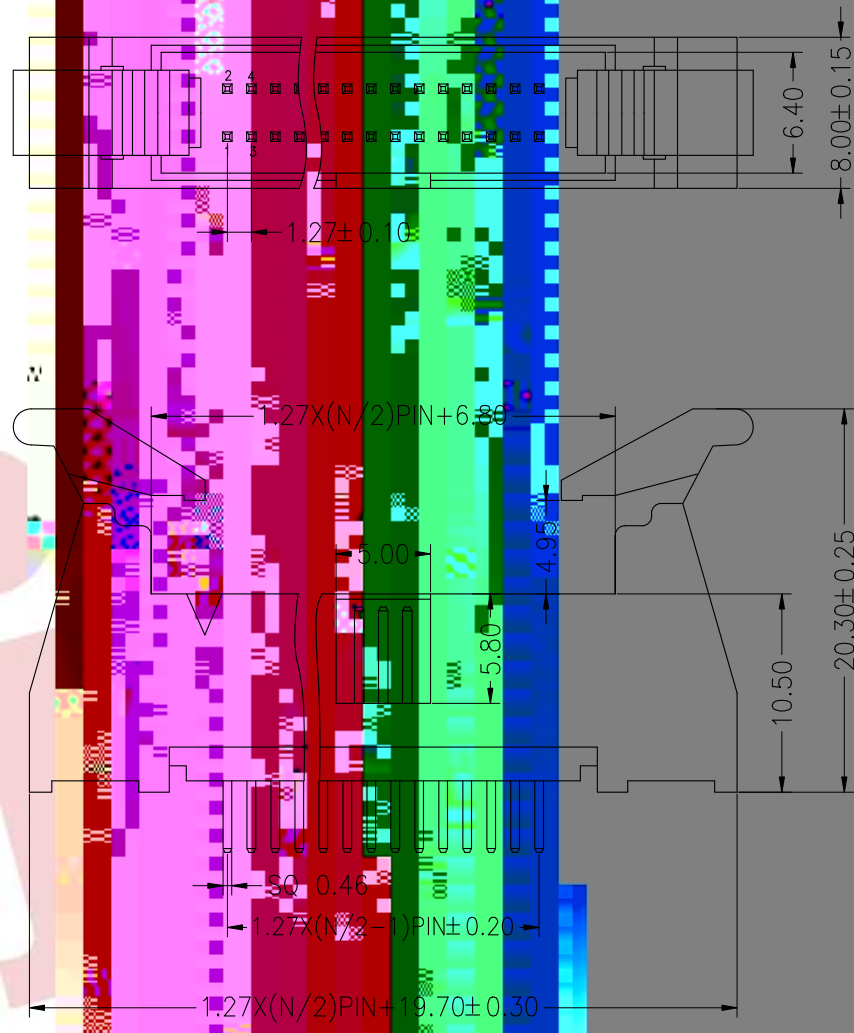
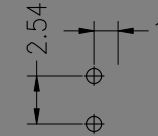

**Ordering Information**

**3340 XX S XX X B L X 0X**

- No.of Pins: 10--100
- Contact Plating: G0:Gold Flash, G1:1u" Gold, G2:1.5u" Gold, G3:2u" Gold, G4:3u" Gold, G5:5u" Gold, G6:10u" Gold, G7:15u" Gold, G8:30u" Gold, S0:Gold Flash/Tin, SN:Tin
- Insulator Material Option: A=BK-PBT, C=BK-PA6T, E=BK-PA9T
- Color Type: B=Black
- Packing: A=Tray, T=Tube, R=Reel

				OPERATION	DRAW	Wei Chen	21.04.14	SCALE	FIT			
				X.X	±0.30			UNIT	mm			
				X.XX	±0.20	CHECK			SIZE	A4	PART NO.	3340XXSXXBLX0X
				X.XXX	±0.10			SHEET	1/1			
A0	2021.04.14	NEW DRAWING		Angle	±3°	APPROVE			PROJ.	TITLE:		1.27*2.54mm ejector header Npin 180°
REV	DATE	MODIFICATION DESCRIPTION		DIM	TOL							